

- Equipped with BK type brake disc, the couplings and brake disc can be installed and removed without moving the drive and driven equipment.
- Torsionally flexible, maintenance-free.
- Light mass, small moment of inertia.
- Damping impact and vibration.
- Axial plug-in, fail-safety.
- Good dynamic properties.
- Maximum torque of elastomer is twice of the rated torque.
- Mounting instructions at 03.109

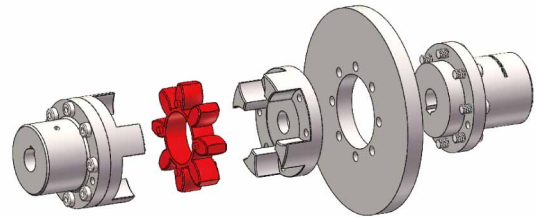
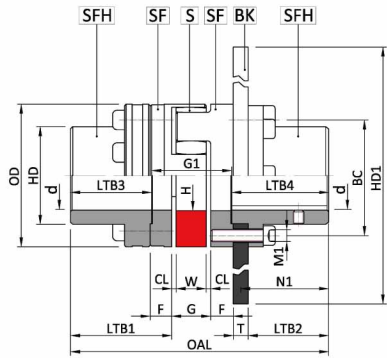

Fig 03.59

03.53

Type														
Size	Spider Rated Torque   N.m			Dimensions   mm										
	92ShA	98ShA	64ShD	DH	DF	D3H7/h7	D4	dH	E	E1	M	Z	CLB	T <sub>A</sub> Nm
65	625	940	1175	135	94	96	116	68	35	65	M10	12	16×22,5°	83
75	1280	1920	2400	160	108	112	136	80	40	75	M12	15	20×18°	120
90	2400	3600	4500	200	140	145	172	100	45	82	M16	15	20×18°	295
100	3300	4950	6185	225	158	165	195	113	50	97	M16	15	20×18°	295
110	4800	7200	9000	255	178	180	218	127	55	103	M20	15	20×18°	580
125	6650	10000	12500	290	206	215	252	147	60	116	M20	15	20×18°	580

03.54

Type												
Size	Finish Bore Diameter d		Max Speed rpm	Max Brake Torque Torque[Nm]2	Dimensions   mm							
	Min,	max			I7	I10	I11	I12	I20	N	L	
65	22	70	3450	1880	16	112.5	113.5	166.0	135	150	344.5	
75	30	80	3250	3840	19	131.5	133.0	166.5	135	150	374.5	
90	40	105	3000	7200	20	164.0	165.5	206.5	175	190	454.0	
100	46	115	2800	9900	25	153.5	155.0	206.5	175	190	458.5	
110	60	130	2600	14400	26	201.5	203.5	212.0	180	195	518.5	
125	60	150	2250	20000	30	198.5	200.5	212.0	180	195	528.5	

03.55

Size	brake disc ØA x b1										
	355 x 30	400 x 30	450 x 30	500 x 30	560 x 30	630 x 30	710 x 30	800 x 30	900 x 30	900 x 40	1000 x 40
65	●	●	●	-	-	-	-	-	-	-	-
75	-	●	●	●	-	-	-	-	-	-	-
90	-	-	●	●	●	●	-	-	-	-	-
100	-	-	-	●	●	●	-	-	-	-	-
110	-	-	-	●	●	●	●	-	-	-	-
125	-	-	-	-	-	●	●	●	-	-	-

- CJ65-90, SF small flange standard material is cast iron, 100-180, SF small flange standard material is ductile iron. SFH flange hub standard material is steel (45#).
- The standard material of the manufacturing plate is tempered steel (45#).
- D is the bore diameter; The metric bore according to ISO fit H7. The feather keyway according to DIN6885 sheet1-JS91. The inch bore is in accordance with AGMA9002-C14 standard, the bore is clearance fit, and the keyway is commercial grade.
- Hexagon socket set screws with cup point is accordance with DIN EN ISO4029, Strength class : 12.9. T<sub>A</sub> is tightening torque, unit: Nm.
- Hexagon socket set screws with cup point is accordance with DIN EN ISO4029, hardness class 45H. T<sub>A</sub> is tightening torque, unit: Nm.
- CLB: Circumferential Layout Bolts